

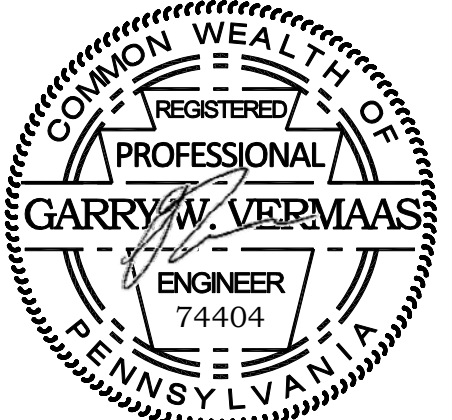

BASE4

BASE4
3858 GLADES ROAD, #31
BOCA RATON, FLORIDA 33434
112012BASE4 www.base-4.com

SEAL



GARRY VERMAAS, PhD, PE
9011 EDGEWATER BEND
PARKLAND, FLORIDA, 33076



ISSUE:

Issued for Permit
08.05.2016

PROJECT: 16-018

Hampton Inn & Suites

New Stanton, PA 15672

OWNER:

Stanton Hospitality LLC

52 Blueberry Lane,
Grove City, PA 16127

No.	Issue Date	Project Status

DATE	2016.08.05
DRAWN BY	JP
CHECKED BY	GWV
SCALE	AS NOTED

PROJECT NO. B4-67-1603
SHEET NAME

UNIT SANITARY &
VENT PLAN

SHEET NO.

P207

STUDIO SEWER LOAD SUMMARY	
FIXTURE	DFU
WCL-01	4.0
WCL-02	4.0
LAV-01	2.0
TUB-01	2.0
SHR-01	2.0
SHR-02	2.0
SNK-01	2.0

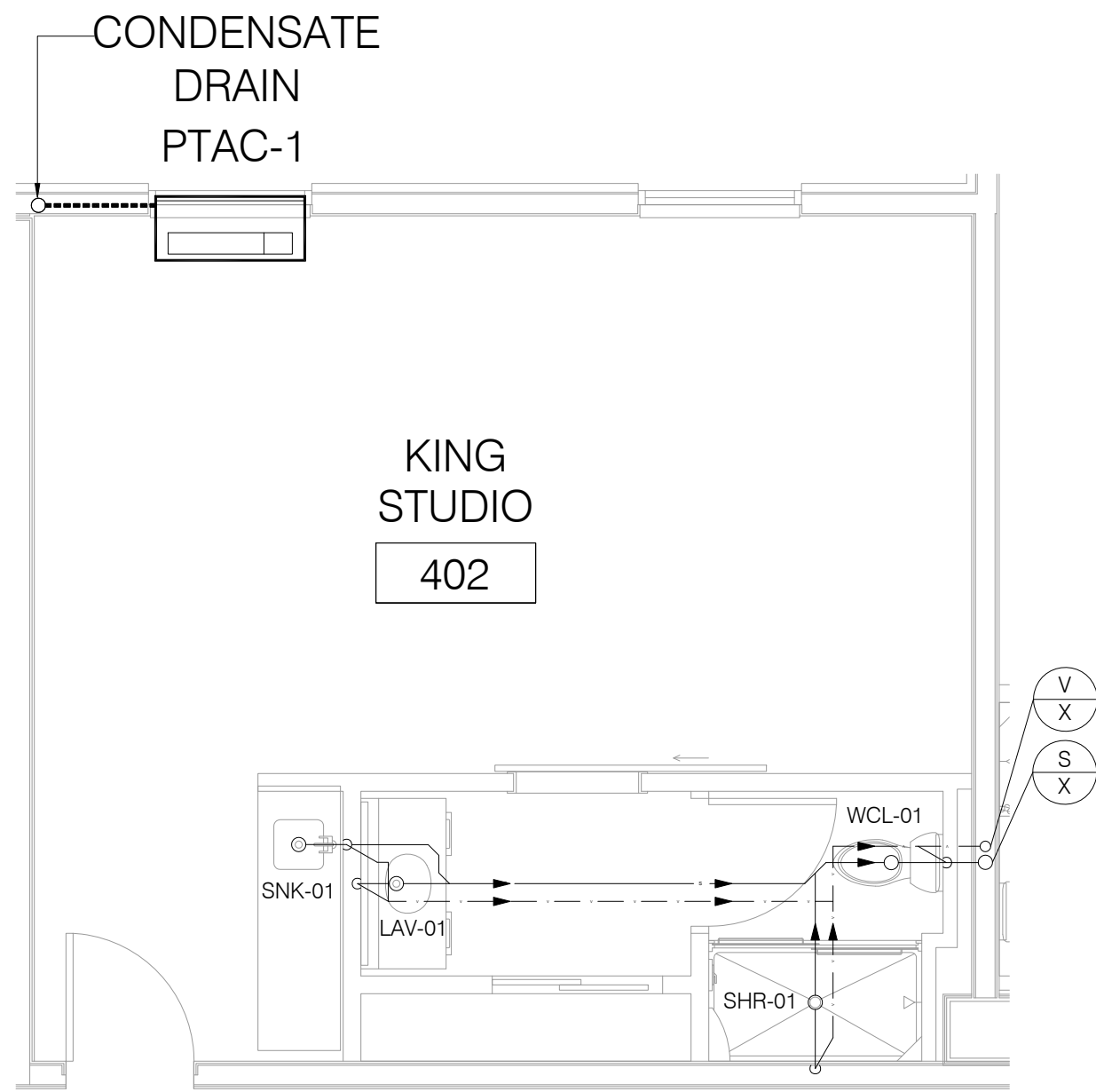

1 KING STUDIO SANITARY & VENT PLAN

SCALE: 1/4" = 1'-0"

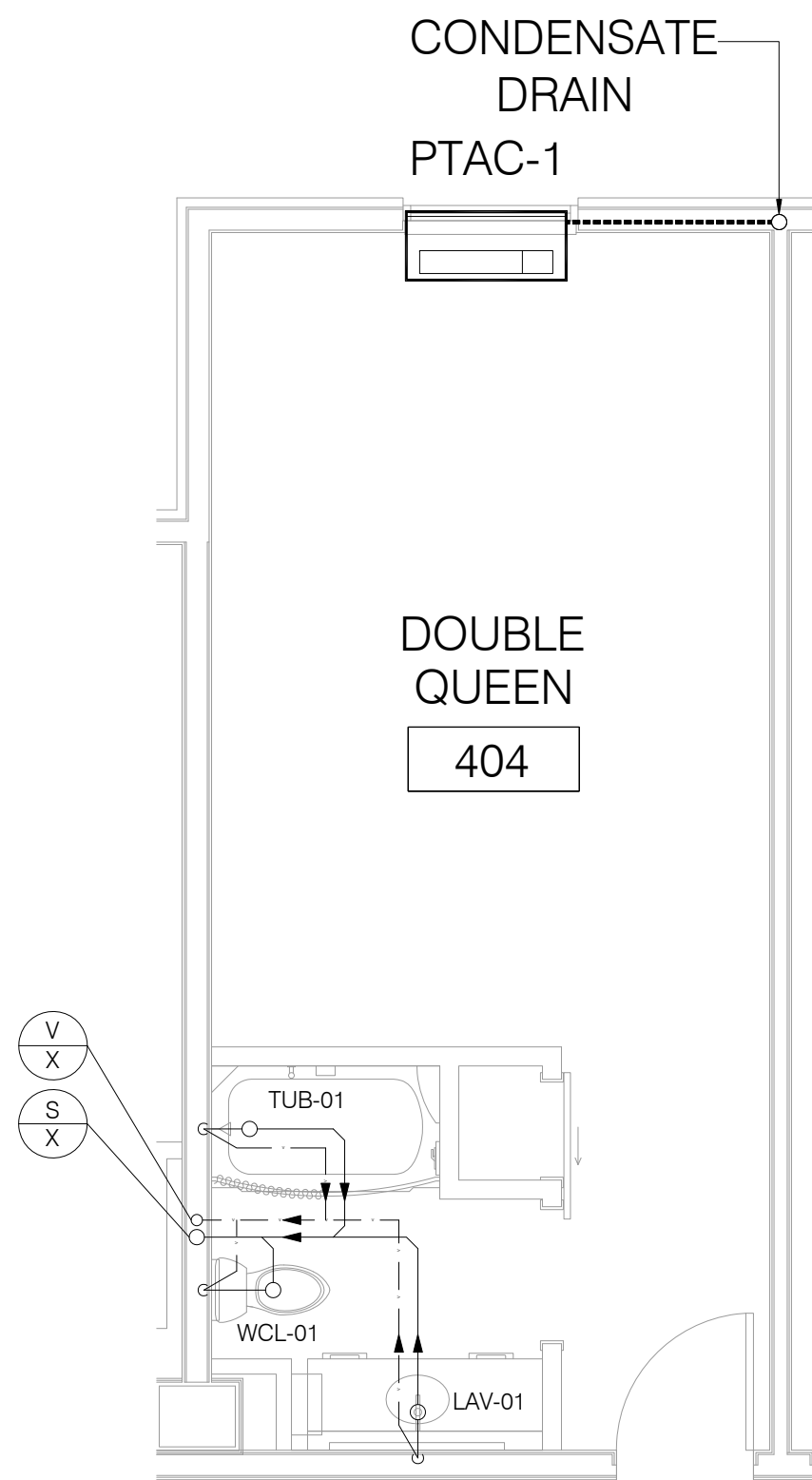

2 DOUBLE QUEEN SANITARY & VENT PLAN

SCALE: 1/4" = 1'-0"

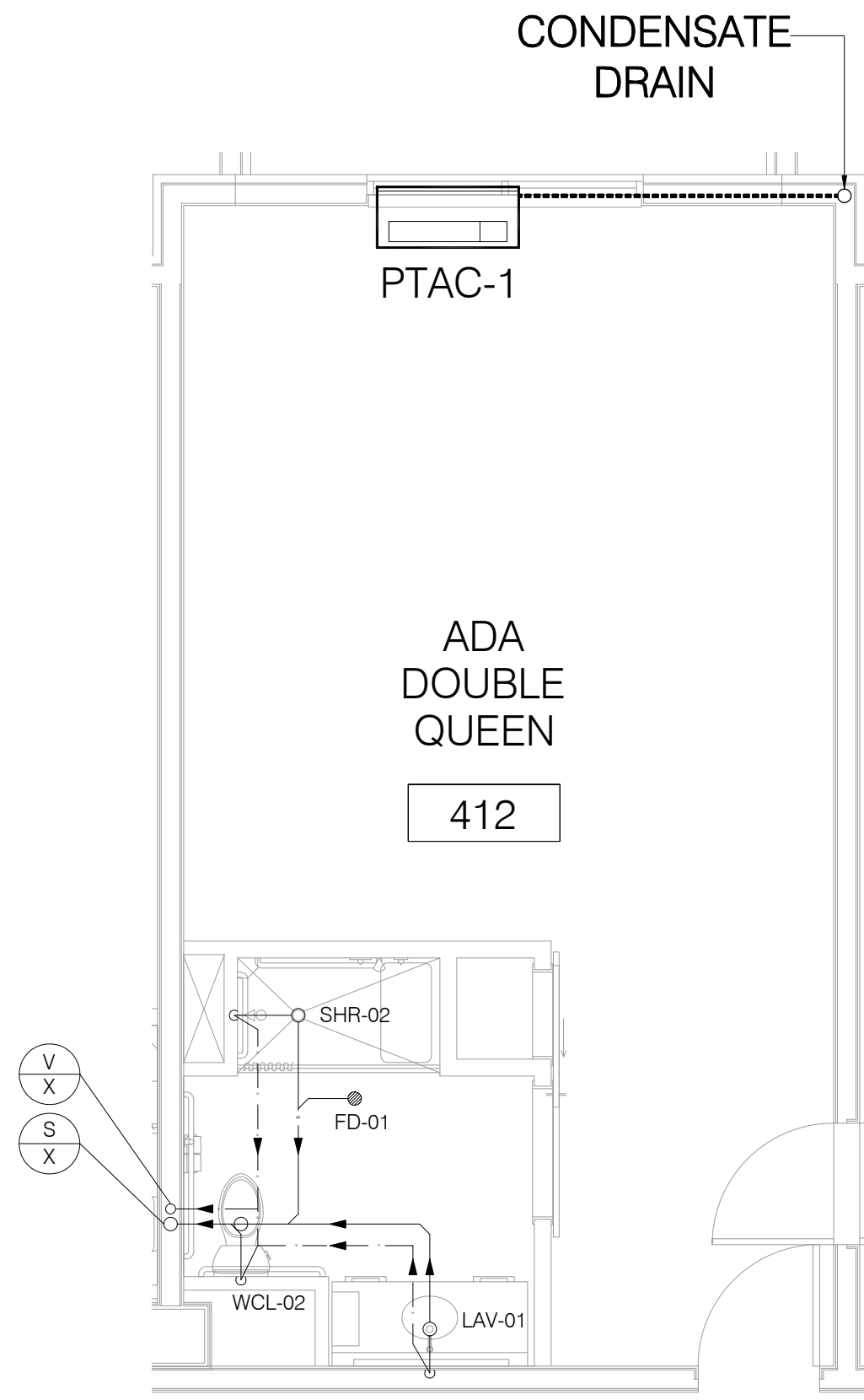

3 ADA DOUBLE QUEEN SANITARY & VENT PLAN

SCALE: 1/4" = 1'-0"



4 KING SOFA SANITARY & VENT PLAN

SCALE: 1/4" = 1'-0"

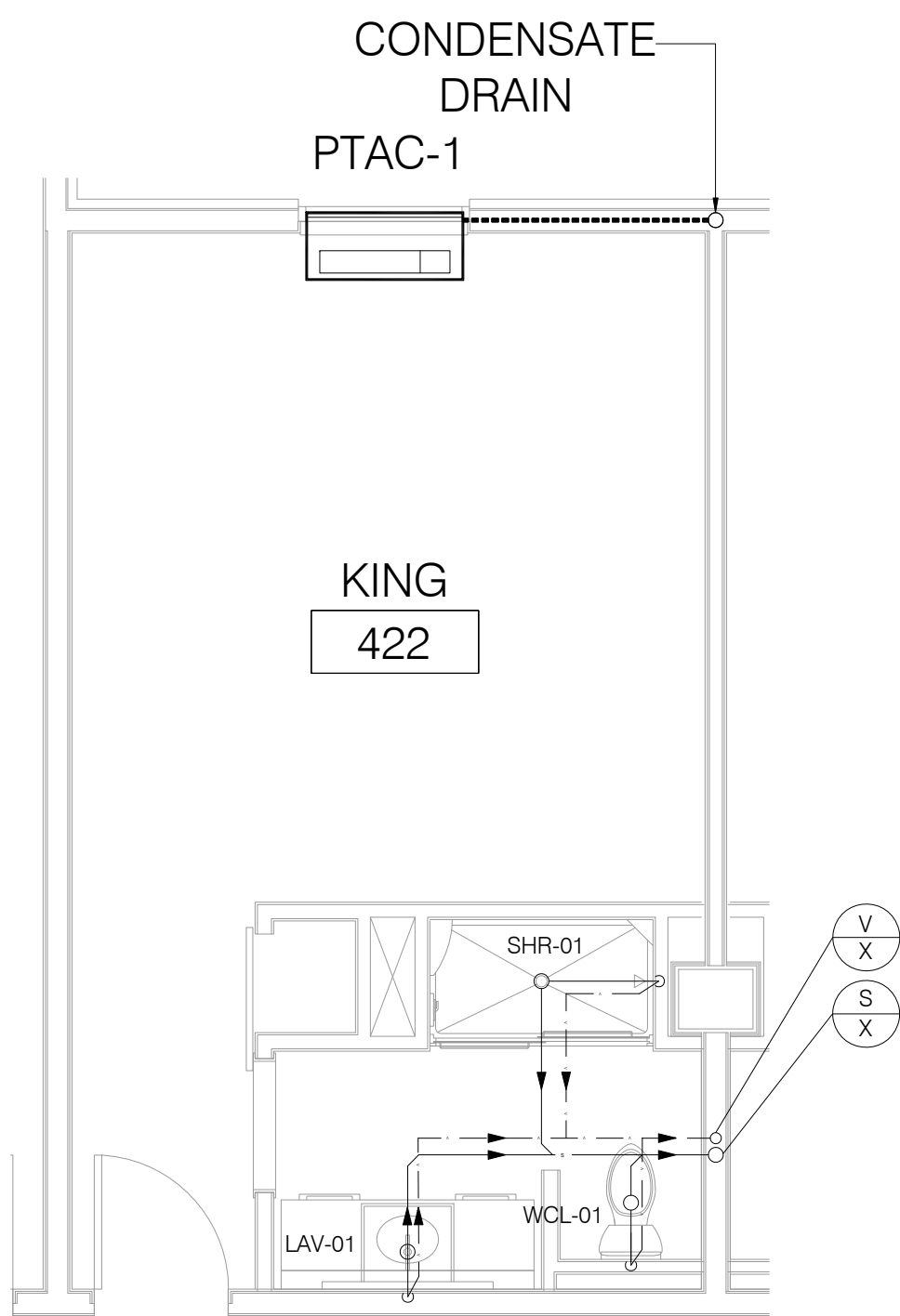

5 KING SANITARY & VENT PLAN

SCALE: 1/4" = 1'-0"

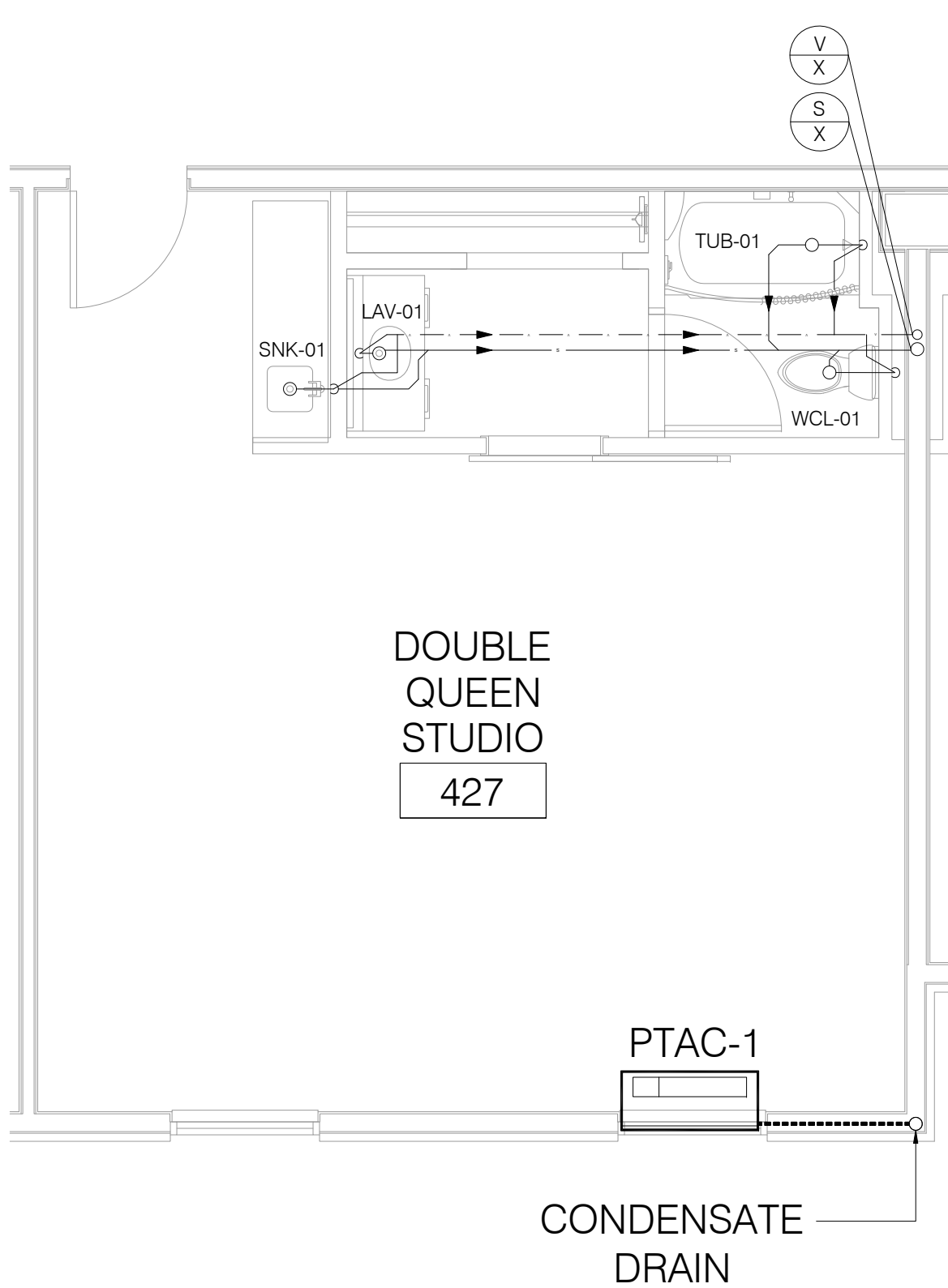

6 DOUBLE QUEEN STUDIO SANITARY & VENT PLAN

SCALE: 1/4" = 1'-0"

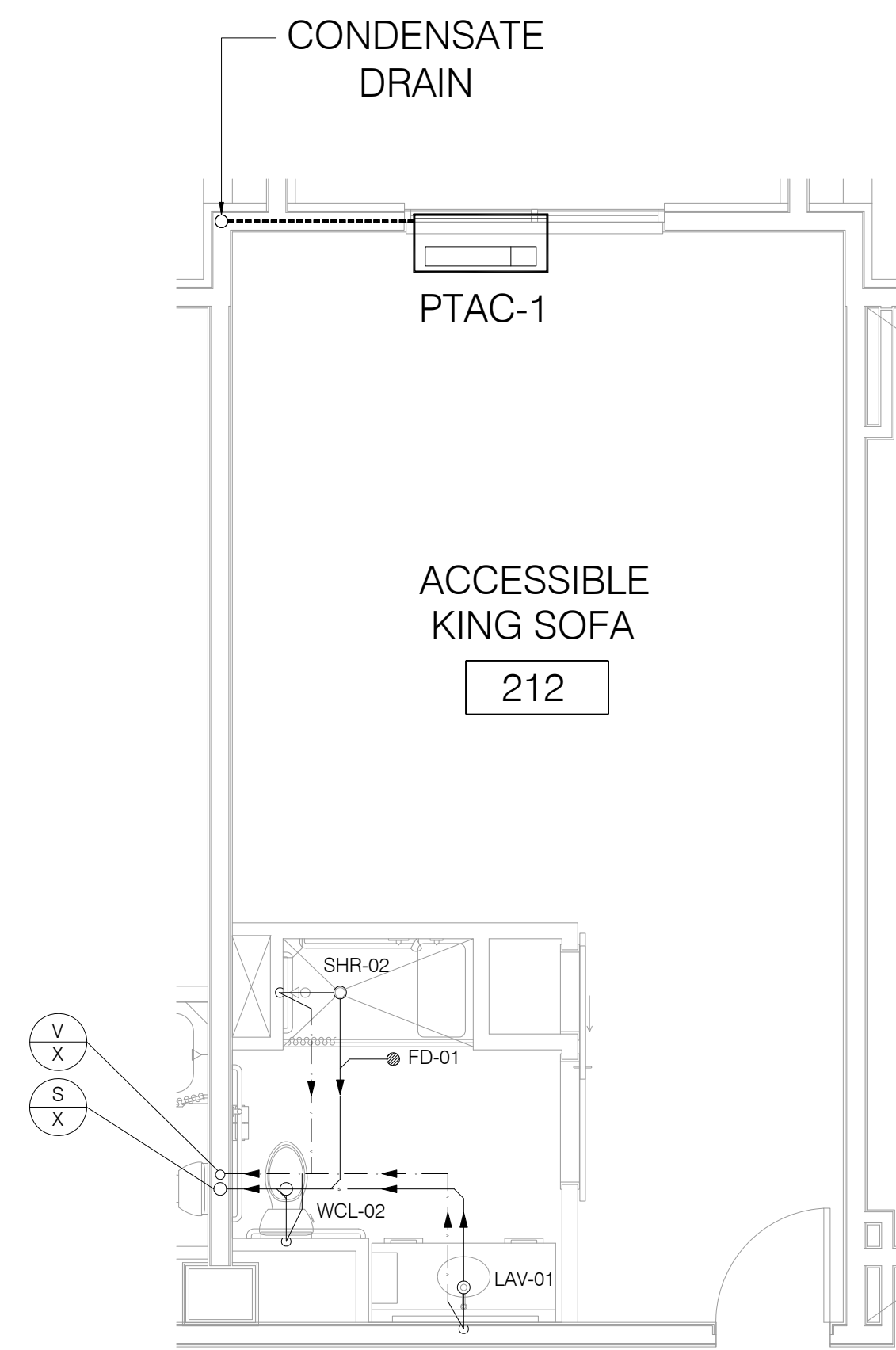

7 ACCESSIBLE KING SOFA SANITARY & VENT PLAN

SCALE: 1/4" = 1'-0"

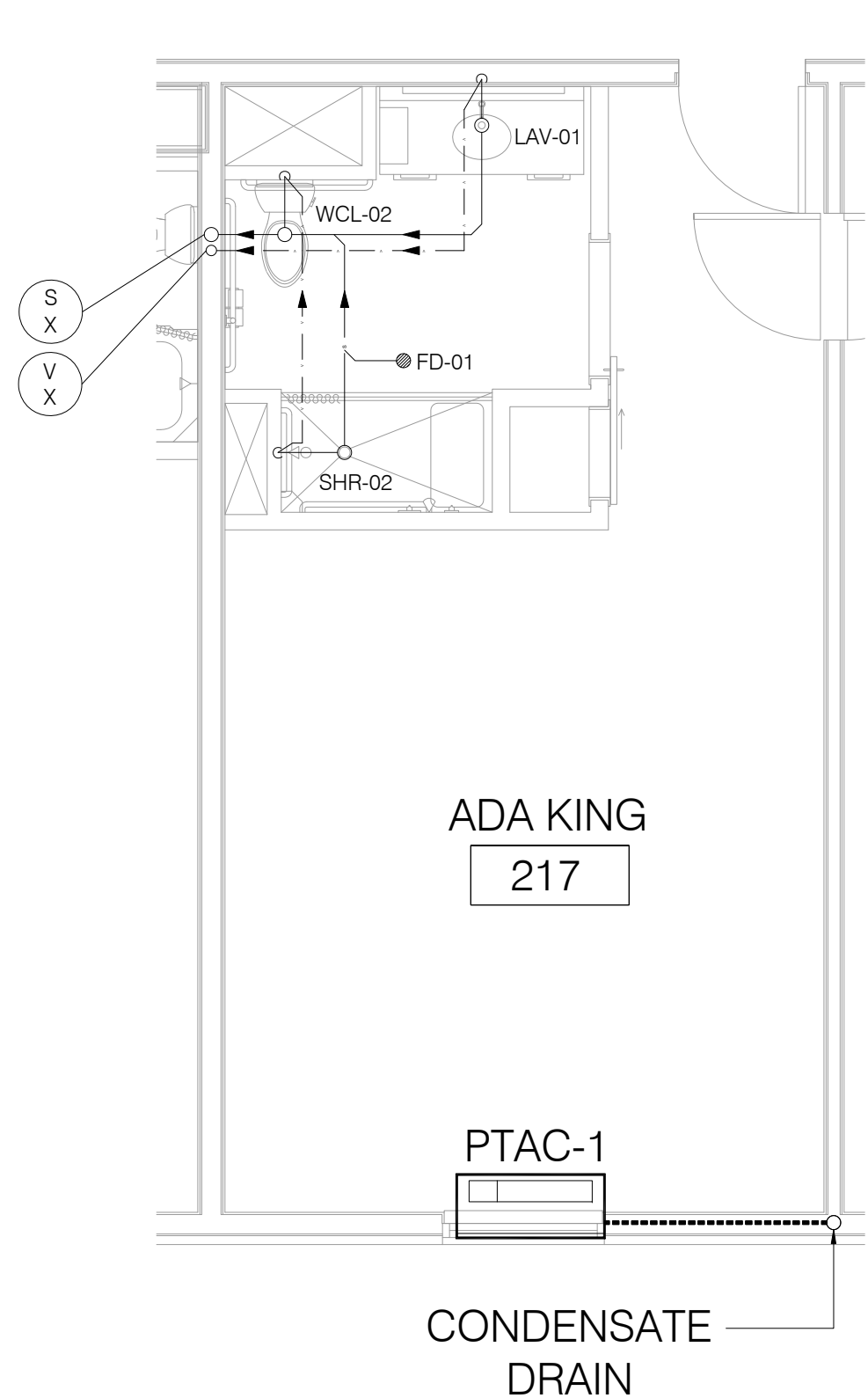

8 ADA KING SANITARY & VENT PLAN

SCALE: 1/4" = 1'-0"

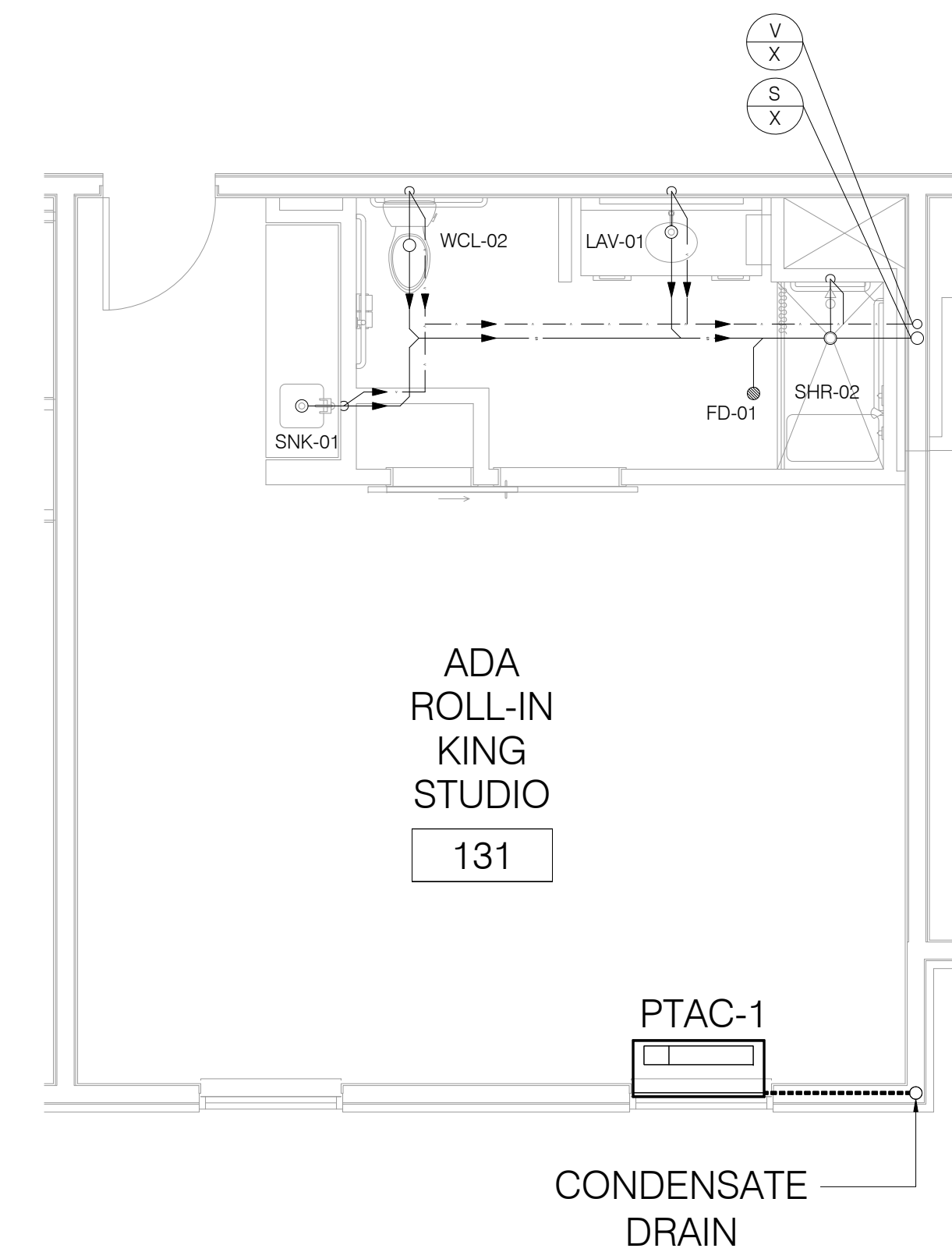

9 ADA ROLL-IN KING STUDIO SANITARY & VENT PLAN

SCALE: 1/4" = 1'-0"